

2	Human Resources	
2	Institutional Development	
3	Math and Writing Center	LAC 1, LAC 2
4	Faculty Offices	FAC-1
5	Lummi Day School	LS-114, LS-115, LS-116
5	Elders	LS-102, LS-103
5	Service Learning	
5A	Faculty Offices	
5B	Maintenance/Custodian	
6	Classroom Building	
7	Cultural Arts Center	CAC
7A	Cultural Learning Center	Log Building
8	Computers Building/Security	C-1, C-2
9	Accounting/Finance Department	
10	Tribal Health	
10	Purchasing/Receiving	
11	Science Building	DL-1, DL-2, D-3, SC-1, SC-2
12	Wooden Shelter	
13	Bookstore/GED	SAC-1, SAC-2
14	Student Union	
15	Kwina Building/TGBM	KW104, KW112, KW113, KW114
16	Native Environmental Science Building	NE112, NE113, NE114, NE106
17	Center for Student Success	
18	Early Childhood Learning Center	
19	Student Housing/Dining Hall	
20	Cooperative Extension	CEB1 (Kitchen), CEB2 (Classroom)
21	Coast Salish Institute	CSI-18, CSI-19, CSI-21, CSI-30
22	Salish Sea Research Center	
23	Library/Technology	
24	Future Health & Wellness Center	
25	Future Workforce Training	

NORTH CAMPUS

SHORE DRIVE

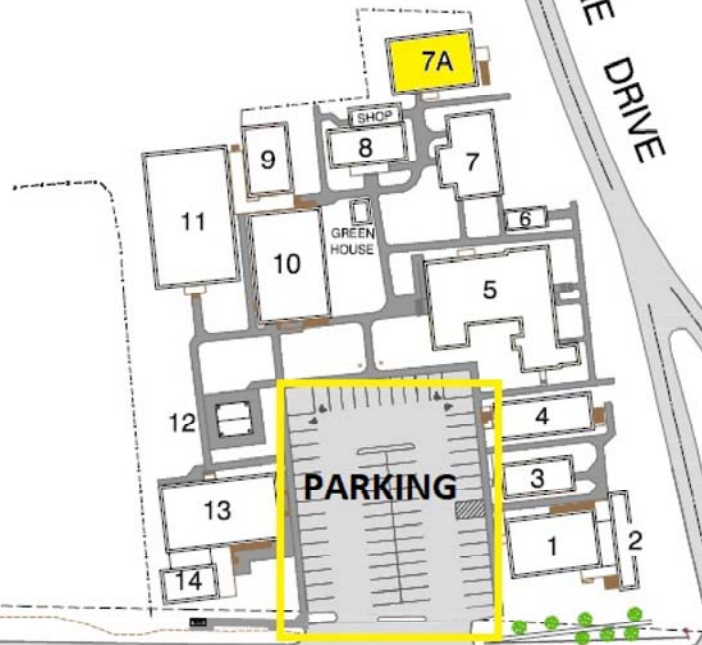

KWINA RD.

MARINE DRIVE

SAINT JOACHIM'S CHURCH

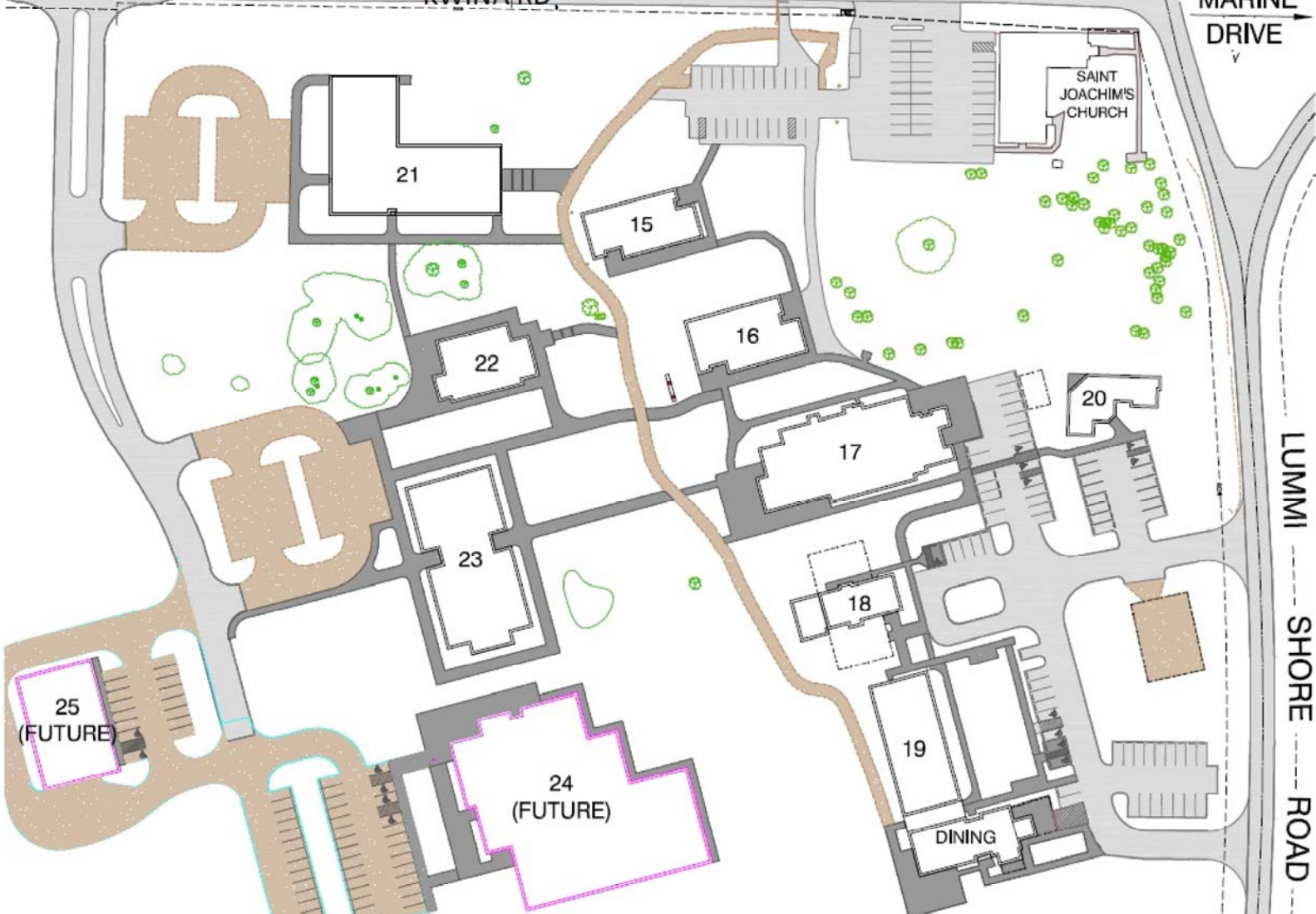

LUMMI SHORE ROAD

SOUTH CAMPUS